

Model	DJF for F400 / 410	Volt/Hz	Date of Modification	Serial Number
Modified Article	Parts Catalog			
Reason for Modification	Parts catalog correction			

Could you please correct your parts catalog as follows:

Incorrect P/N	Correct P/N	Description	Q'ty Used	Parts Catalog	
				Index No.	Page
A3762195	A3762196	Transport Belt	1	2	13

S. Hamano, Assistant General Manager
Technical Support Department

MODEL NAME	V/Hz	DESTINATION	JAPAN PRODUCTION	
			CODE	SERIAL NUMBER
NRG CRF55	120/60	U.S.A. , Canada etc.	A376 - 10	
Savin ARDF2	120/60	U.S.A	A376 - 15	
Ricoh DF60	120/60	U.S.A	A376 - 17	
NRG CRF55	230/50	Europe etc.	A376 - 22	
Infotec ARDF VII	230/50	Europe	A376 - 26	
Ricoh DF60	230/50	Europe etc.	A376 - 27	

Model	DJF for F400/410	Volt/Hz	Date of Modification	Serial Number
Modified Article	Parts Catalog			
Reason for Modification	Parts catalog correction			

Please correct your parts catalog as follows:

Incorrect P/N	Correct P/N	Description	Q'ty Used	Parts Catalog	
				Index No.	Page
12041123	12042367	Microswitch	1	111	11
		Microswitch - 250 VAC/0.1A			

S. Hamano, Assistant General Manager
Technical Support Department

MODEL NAME	V/Hz	DESTINATION	JAPN PRODUCTION	
			CODE	SERIAL NUMBER
NRG CRF55	120/60	U.S.A. , Canada etc.	A376 - 10	
Savin ARDF2	120/60	U.S.A	A376 - 15	
Ricoh DF60	120/60	U.S.A	A376 - 17	
NRG CRF55	230/50	Europe etc.	A376 - 22	
Infotec ARDF VII	230/50	Europe	A376 - 26	
Ricoh DF60	230/50	Europe etc.	A376 - 27	

Model	DJF for F400/410	Volt/Hz	Date of Modification	Serial Number
Modified Article	Feed Roller Guide and Holder - Feed Roller Guide			
Reason for Modification	To prevent the original multiple feeding			

To prevent the original multiple feeding, the feed roller guide and holder have been changed. For details please refer to RTB No. 008.

Old P/N	New P/N	Description	Q'ty Used	Inter-change-ability	Parts Catalog	
					Index No.	Page
A3761252		Feed Roller Guide	2 → 0	X/	38	9
A3761253		Holder - Feed Roller Guide	2 → 0	X/	41	9
	A3761254	Feed Roller Guide	0 → 2	/O	*42	9

* New Index

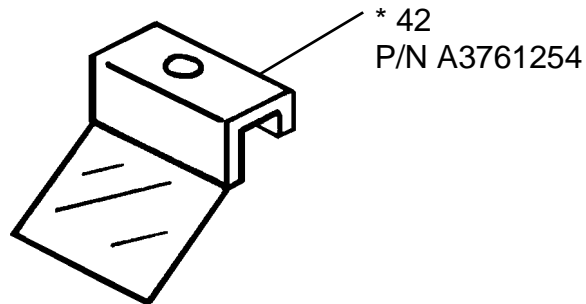

S. Hamano, Assistant General Manager
Technical Support Department

MODEL NAME	V/Hz	DESTINATION	JAPAN PRODUCTION	
			CODE	SERIAL NUMBER
NRG CRF55	120/60	U.S.A. , Canada etc.	A376 - 10	5373110001
Savin ARDF2	120/60	U.S.A.	A376 - 15	4123110001
Ricoh DF60	120/60	U.S.A.	A376 - 17	A3383110001
NRG CRF55	230/50	Europe etc.	A376 - 22	5323110001
Infotec ARDF VII	230/50	Europe	A376 - 26	3D81130001
Ricoh DF60	230/50	Europe etc.	A376 - 27	A3383110743

Model	DJF for F400/F410	Volt/Hz	Date of Modification	Serial Number
Modified Article	Belt Pressure Roller			
Reason for Modification	To improve the original transportation			

To improve the small size original transportation, one of four belt pressure roller is modified.
 (The diameter is increased from 20mm to 24mm to apply more pressure.)

Old P/N	New P/N	Description	Q'ty Used	Inter-changeability	Parts Catalog	
					Index No.	Page
A37362096	A3762096	Belt Pressure Roller	4 → 3	—	11	13
	A3762097	Belt Pressure Roller - Large	0 → 1	X/O	* 22	13

* New Index

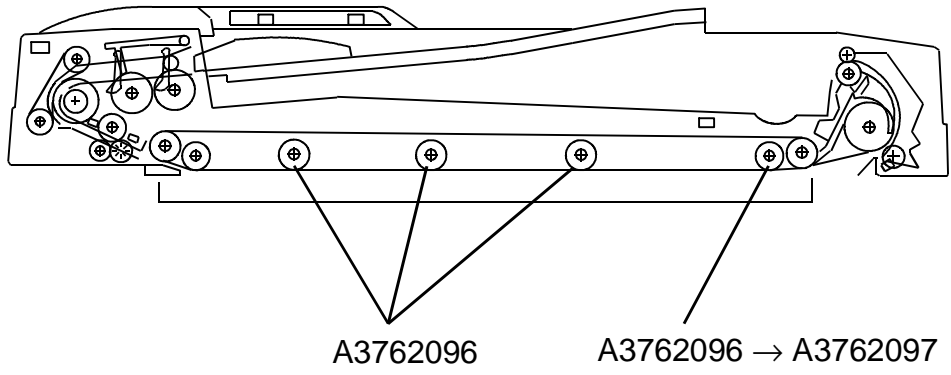

S. Hamano, Assistant General Manager
 Technical Support Department

MODEL NAME	V/Hz	DESTINATION	JAPAN PRODUCTION	
			CODE	SERIAL NUMBER
NRG CRF55	120/60	U.S.A. , Canada etc.	A376 - 10	5373120001
Savin ARDF2	120/60	U.S.A.	A376 - 15	4123120001
Ricoh DF60	120/60	U.S.A.	A376 - 17	A3383120001
NRG CRF55	230/50	Europe etc.	A376 - 22	5323120001
Infotec ARDF VII	230/50	Europe	A376 - 26	3D81230001
Ricoh DF60	230/50	Europe etc.	A376 - 27	A3383120457

Model	DJF for F400 / 410 / 420 and DFC - α	Volt/Hz	Date of Modification	Serial Number
Modified Article	Original Exit Guide Mylar			
Reason for Modification	To ensure original stack in auto counting mode			

To ensure original stack in auto counting mode, the original exit guide mylar has been added as shown. For details please refer to F400 RTB - 033.

P/N	Description	Q'ty Used	Parts Catalog	
			Index No.	Page
A3764577	Original Exit Guide Mylar	0 → 1	* 21	5

* New Index

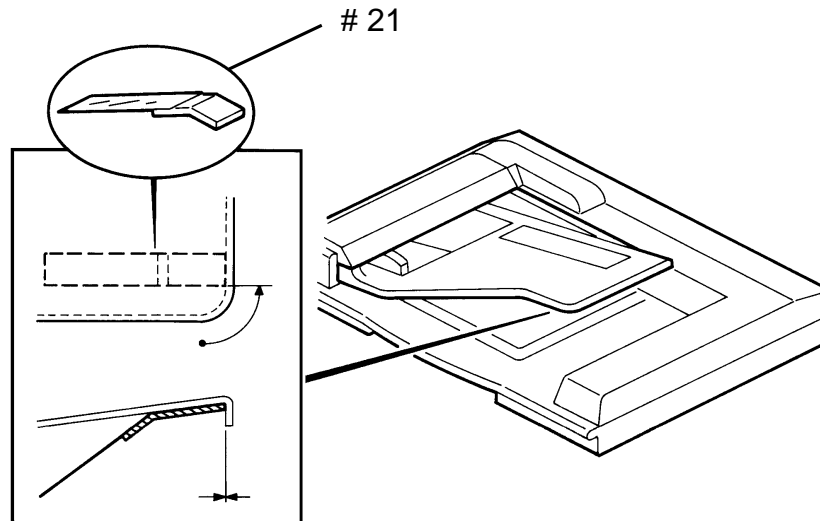

S. Hamano, Assistant General Manager
 Technical Support Department

MODEL NAME	V/Hz	DESTINATION	JAPAN PRODUCTION	
			CODE	SERIAL NUMBER
NRG CRF55	120/60	U.S.A. , Canada etc.	A376 - 10	537405XXXX
Savin ARDF2	120/60	U.S.A	A376 - 15	4124050001
Ricoh DF60	120/60	U.S.A	A376 - 17	A3384050001
NRG CRF55	230/50	Europe etc.	A376 - 22	5324050001
Infotec ARDF VII	230/50	Europe	A376 - 26	3D80540001
Ricoh DF60	230/50	Europe etc.	A376 - 27	A3384050501

Model	DJF for F400 / 410 / 420 and DFC - α	Volt/Hz	Date of Modification	Serial Number
Modified Article	Separation Belt - 4pcs/set			
Reason for Modification	To ensure original feeding			

To ensure original feeding, the material of the separation belts has been changed to the one which less toner adheres to. For details please refer to RTB F400 - 036.

Old P/N	New P/N	Description	Q'ty Used	Parts Catalog	
				Index No.	Page
A3769501	A3769502	Separation Belt - 4pcs/set	1 → 1	8	7

S. Hamano, Assistant General Manager
 Technical Support Department

MODEL NAME	V/Hz	DESTINATION	JAPAN PRODUCTION	
			CODE	SERIAL NUMBER
NRG CRF55	120/60	U.S.A. , Canada etc.	A376 - 10	537403XXXX
Savin ARDF2	120/60	U.S.A	A376 - 15	4124030001
Ricoh DF60	120/60	U.S.A	A376 - 17	A3384030001
NRG CRF55	230/50	Europe etc.	A376 - 22	5324030001
Infotec ARDF VII	230/50	Europe	A376 - 26	3D80340001
Ricoh DF60	230/50	Europe etc.	A376 - 27	A3384030150

Model	DJF for F400 / 410 / 420 / DFC-α	Volt/Hz	Date of Modification	Serial Number
Modified Article	Parts Catalog			
Reason for Modification	Parts catalog correction			

Please correct your parts catalog as follows:
Please add following parts.

New P/N	Description	Q'ty Used	Parts Catalog	
			Index No.	Page
54221737	Shaft	1	* 43	9

* New Index

Page 10

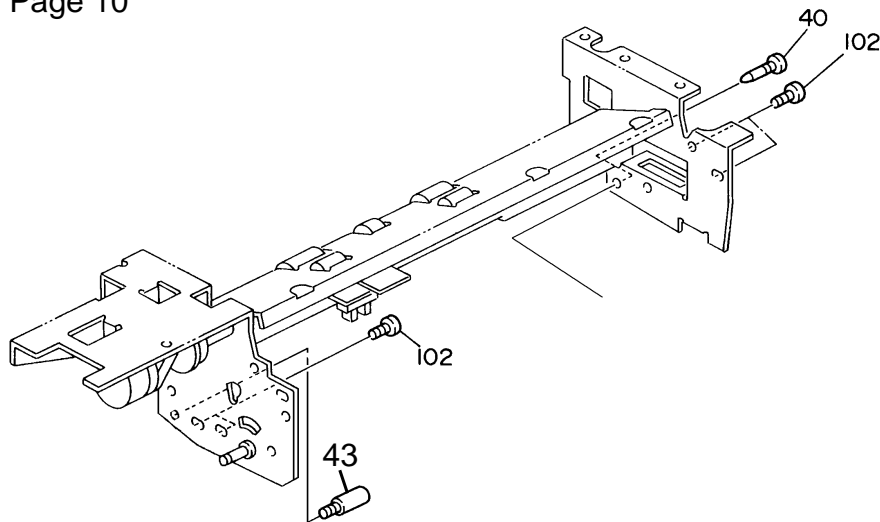

S. Hamano, Assistant General Manager
Technical Support Department

MODEL NAME	V/Hz	DESTINATION	JAPAN PRODUCTION	
			CODE	SERIAL NUMBER
NRG CRF55	120/60	U.S.A. , Canada etc.	A376 - 10	/
Savin ARDF2	120/60	U.S.A	A376 - 15	
Ricoh DF60	120/60	U.S.A	A376 - 17	
NRG CRF55	230/50	Europe etc.	A376 - 22	
Infotec ARDF VII	230/50	Europe	A376 - 26	
Ricoh DF60	230/50	Europe etc.	A376 - 27	

Model	DJF for F400 / 410 / 420 / DFC-α	Volt/Hz	Date of Modification	Serial Number
Modified Article	Guide Stud			
Reason for Modification	To prevent the upper registration guide from turning over the stopper.			

The upper registration guide contracts under a low temperature condition, and the side play of the guide becomes wider. This allows the guide to turn over the stopper in some cases. To prevent this by limiting the side play of the guide, the shaft has been changed in shape and a retaining ring has been added.

Old P/N	New P/N	Description	Q'ty Used	Inter-change-ability	Parts Catalog	
					Index No.	Page
A4693350		Guide Stud	1 → 0	X/O	13	9
	C2175524	Stud - Front Release Lever	0 → 1			
	07200040B	Retaining Ring - M4	n → n+1		103	9

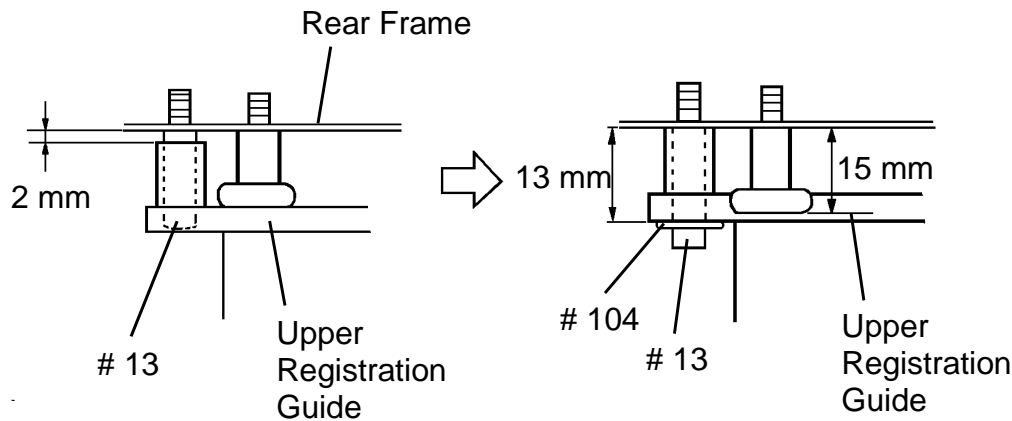

S. Hamano, Assistant General Manager
 Technical Support Department

MODEL NAME	V/Hz	DESTINATION	JAPAN PRODUCTION	
			CODE	SERIAL NUMBER
NRG CRF55	120/60	U.S.A. , Canada etc.	A376 - 10	5374070001
Savin ARDF2	120/60	U.S.A	A376 - 15	4124030015
Ricoh DF60	120/60	U.S.A	A376 - 17	A3384030001
NRG CRF55	230/50	Europe etc.	A376 - 22	5324040001
Infotec ARDF VII	230/50	Europe	A376 - 26	3D80440001
Ricoh DF60	230/50	Europe etc.	A376 - 27	A3384040802

Model	DJF for F400 / 410 / 420 / DFC-α	Volt/Hz	Date of Modification	Serial Number
Modified Article	Timing Belt			
Reason for Modification	To reduce the mechanical driving noise			

To reduce the mechanical driving noise, the material of the timing belt has been

Old P/N	New P/N	Description	Q'ty Used	Inter-change-ability	Parts Catalog	
					Index No.	Page
AA043096	AA043245	Timing Belt - 4 x 160	1 → 1	X/O	16	17
		Timing Belt - B60S2M160				

S. Hamano, Assistant General Manager
 Technical Support Department

MODEL NAME	V/Hz	DESTINATION	JAPAN PRODUCTION	
			CODE	SERIAL NUMBER
NRG CRF55	120/60	U.S.A. , Canada etc.	A376 - 10	5374070001
Savin ARDF2	120/60	U.S.A	A376 - 15	4124070001
Ricoh DF60	120/60	U.S.A	A376 - 17	A3384070490
NRG CRF55	230/50	Europe etc.	A376 - 22	5324080001
Infotec ARDF VII	230/50	Europe	A376 - 26	3D80840001
Ricoh DF60	230/50	Europe etc.	A376 - 27	A3384080758

Model	DJF for F400 / 410 / 420 / DFC-α	Volt/Hz	Date of Modification	Serial Number
Modified Article	Philips Screw with Flat Washer - M4 x 8			
Reason for Modification	To ensure DJF height			

When installing the DJF on the copier, the fixing screws of the reset switch lever touch the DJF lower middle cover and deviate the DJF height in some cases.
To prevent this, the fixing screw has been changed.

Old P/N	New P/N	Description	Q'ty Used	Inter-change-ability	Parts Catalog	
					Index No.	Page
09514008B	58752088	Philips Screw with Flat Washer - M4 x 8	n → n-2	X/	105	17
		Shoulder Screw - M4	0 → 2	/O	31	17

S. Hamano, Assistant General Manager
Technical Support Department

MODEL NAME	V/Hz	DESTINATION	JAPAN PRODUCTION	
			CODE	SERIAL NUMBER
NRG CRF55	120/60	U.S.A. , Canada etc.	A376 - 10	5374070001
Savin ARDF2	120/60	U.S.A	A376 - 15	4124050001
Ricoh DF60	120/60	U.S.A	A376 - 17	A3384050001
NRG CRF55	230/50	Europe etc.	A376 - 22	5324050001
Infotec ARDF VII	230/50	Europe	A376 - 26	3D80540001
Ricoh DF60	230/50	Europe etc.	A376 - 27	A3384050501

Model	DJF for F400 / 410 / 420 / DFC-α	Volt/Hz	Date of Modification	Serial Number
Modified Article	Main Control Board			
Reason for Modification	To improve reliability			

Old P/N	New P/N	Description	Q'ty Used	Inter-change-ability	Parts Catalog	
					Index No.	Page
A3765551	A3765560	Main Board	1 → 1	X/O	22	17
A3766821	A3766825	IC - AM27C256 - 150DC	1 → 1	X/O	28	17
11070404		Fuse - 0.3A 250V	1 → 0		116	17

If FU102 is blown, the original feed motor rotates continuously and the main board might be damaged. To prevent this, the circuit of the main board and software have been changed.

1. Main Board

- (1) FU102 is eliminated.
- (2) R600 is added to protect R301.

2. Software

- (1) When +12V line is shorted, (P) jam will be indicated.
- (2) When +5V line is shorted, LED indicator will be turned off and DJF will stop.

S. Hamano, Assistant General Manager
 Technical Support Department

MODEL NAME	V/Hz	DESTINATION	JAPAN PRODUCTION	
			CODE	SERIAL NUMBER
NRG CRF55	120/60	U.S.A. , Canada etc.	A376 - 10	5374080001
Savin ARDF2	120/60	U.S.A	A376 - 15	4124080001
Ricoh DF60	120/60	U.S.A	A376 - 17	A3384080001
NRG CRF55	230/50	Europe etc.	A376 - 22	5324080018
Infotec ARDF VII	230/50	Europe	A376 - 26	3D80840001
Ricoh DF60	230/50	Europe etc.	A376 - 27	A3384091531

Model	DJF for F400/410/420, DFC - α	Volt/Hz	Date of Modification	Serial Number
Modified Article	Reset Switch Lever			
Reason for Modification	To prevent the reset switch from being broken			

Draw No.	Old Parts No.	New Parts No.	Description	Rank	Q'ty Used Old→New	Inter-changeability	Parts needed for replacement by new part		Parts Catalog	
							Part No.	Description	No.	Page
	A3764916	A3764917	Reset Switch Lever		1 → 1	X/X			24	17
	03130140B		Philips Pan Head Screw - M3 x 14		n → n-2	X/	as a set (A3769520) X/O		112	17
		54423903	Pin - Pick-off Pawl Slide		0 → 2	/X			* 32	17
		AA130040	Roller		0 → 2				* 33	17
		A3764918	Spring Plate		0 → 1				* 34	17
		A3769520	Reset Switch Lever Set		0 → 1				* 35	17
									* New Index	

Rank: A : Replace with new parts immediately. B : Replace with new parts at time of repair. C : Replace with new parts at time of overhaul.

Interchangeability:

(1) When old and new parts are not mutually interchangeable, use additional parts or an assembly part as indicated in "Parts needed for replacement by new part" to install the new part.

(2) The mark to the left of the slash indicates whether the old part can be used in the new machine, and the mark to the right indicates whether the new part can be used in the old machine. x = Not interchangeable o = Interchangeable

DETAILS OF MODIFICATION

To prevent the reset switch lever (Index No. 24) from being broken, a spring plate (P/N A3764918) which works as a cushion has been added as shown.

When the old lever (P/N A3764916) is broken, please install the new parts as a set, because the old one will not be supplied as a service part. The set part number is A3769520.

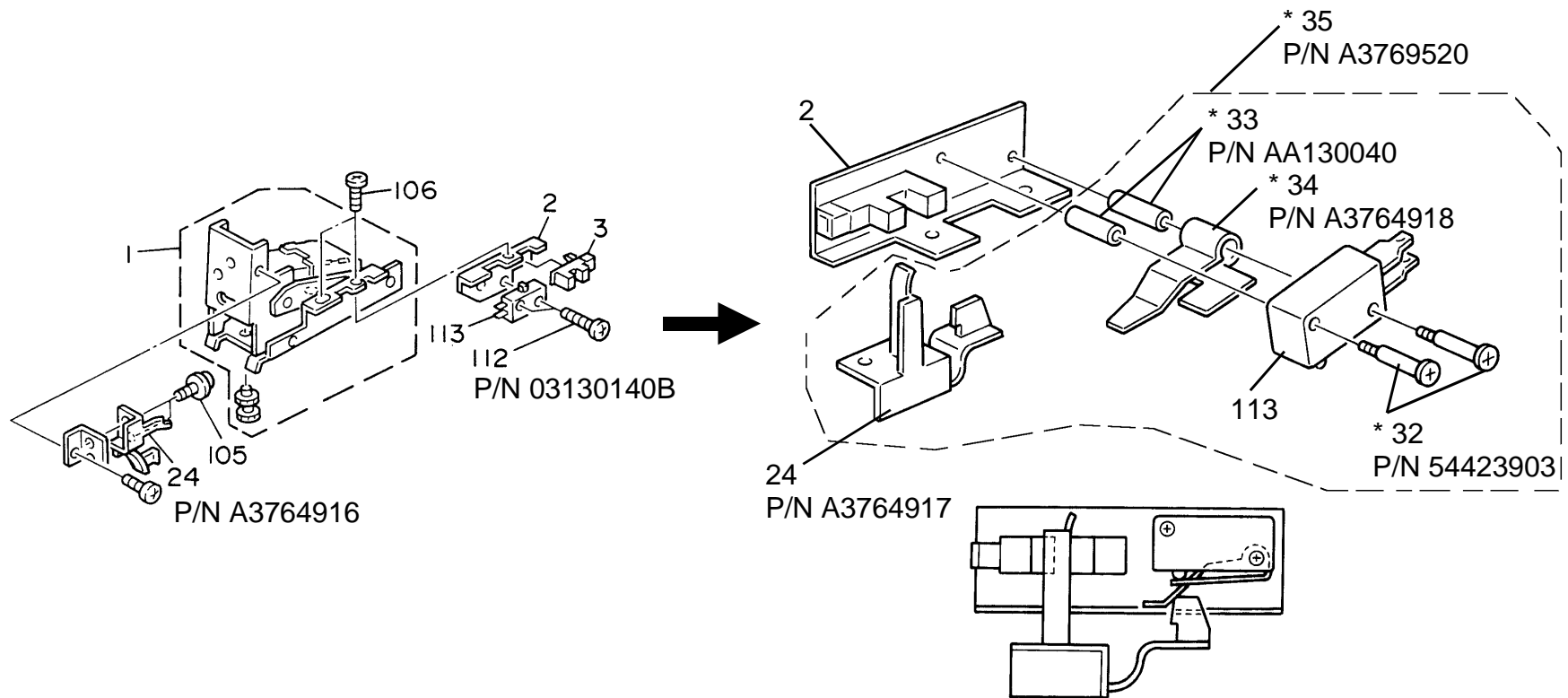

S. Hamano, Assistant General Manager
 Technical Support Department

MODEL NAME	V/Hz	DESTINATION	JAPAN PRODUCTION	
			CODE	SERIAL NUMBER
NRG CRF55	120/60	U.S.A. , Canada etc.	A376 - 10	5374120001
Savin ARDF2	120/60	U.S.A	A376 - 15	4125010001
Ricoh DF60	120/60	U.S.A	A376 - 17	A3384120001
NRG CRF55	230/50	Europe etc.	A376 - 22	5324120001
Infotec ARDF VII	230/50	Europe	A376 - 26	3D81240001
Ricoh DF60	230/50	Europe etc.	A376 - 27	A3384121661

Model	DJF for F400 / 410 / 420, DFC - α	Volt/Hz	Date of Modification	Serial Number
Modified Article	Main Board			
Reason for Modification	To improve original stacking			

To ensure that the original braking circuit for original feed-out works properly all the time, the resistor on the main board has been changed.

Accordingly the part number of the main board has been changed.

Old P/N	New P/N	Description	Q'ty Used	Inter-change-ability	Parts Catalog	
					Index No.	Page
A3765560	A3765570	Main Board	1 → 1	O/O	22	17

S. Hamano, Assistant General Manager
 Technical Support Department

MODEL NAME	V/Hz	DESTINATION	JAPAN PRODUCTION	
			CODE	SERIAL NUMBER
NRG CRF55	120/60	U.S.A. , Canada etc.	A376 - 10	
Savin ARDF2	120/60	U.S.A.	A376 - 15	
Ricoh DF60	120/60	U.S.A.	A376 - 17	
NRG CRF55	230/50	Europe etc.	A376 - 22	
Infotec ARDF VII	230/50	Europe	A376 - 26	
Ricoh DF60	230/50	Europe etc.	A376 - 27	

Model	DJF for F400 / 410 / 420, DFC - α	Volt/Hz	Date of Modification	Serial Number
Modified Article	Hinges			
Reason for Modification	To increase durability			

To increase the durability of the left and right hinges, two bushings have been added as shown below.

Old P/N	New P/N	Description	Q'ty Used	Inter-changeability	Parts Catalog	
					Index No.	Page
A3764160	A3764159	Left Hinge	1 → 1	X/O	1	17
A3764190	A3764189	Right Hinge	1 → 1	X/O	5	17

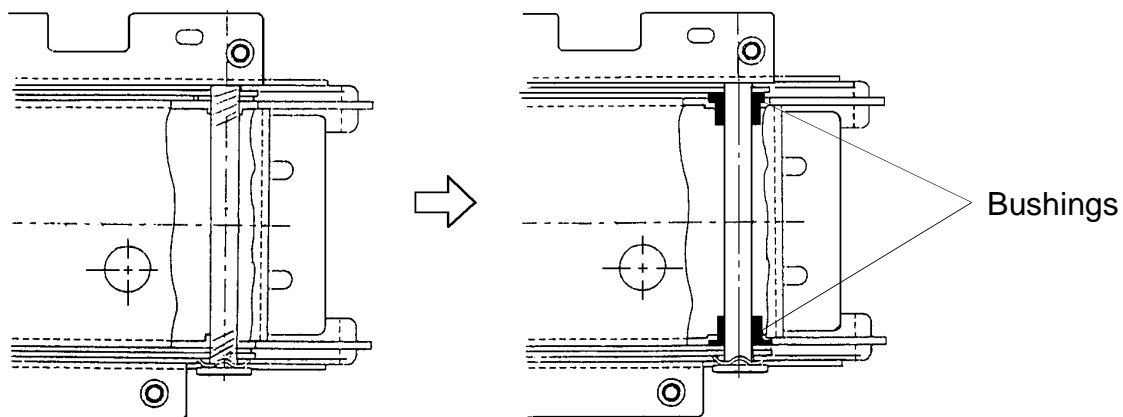

S. Hamano, Assistant General Manager
 Technical Support Department

MODEL NAME	V/Hz	DESTINATION	JAPAN PRODUCTION	
			CODE	SERIAL NUMBER
NRG CRF55	120/60	U.S.A. , Canada etc.	A376 - 10	5374100001
Savin ARDF2	120/60	U.S.A.	A376 - 15	4124100001
Ricoh DF60	120/60	U.S.A.	A376 - 17	A3384100001
NRG CRF55	230/50	Europe etc.	A376 - 22	5324100001
Infotec ARDF VII	230/50	Europe	A376 - 26	3D81040001
Ricoh DF60	230/50	Europe etc.	A376 - 27	A3384101037

Model	DJF for F400 / 410 / 420	Volt/Hz	Date of Modification	Serial Number
Modified Article	Feed Roller Guide			
Reason for Modification	To prevent the transport belt going behind the frame.			

To prevent the transport belt going behind the rear transport frame and being pressed by book originals when the DJF is closed, the guide mylar has been added.

New P/N	Description	Q'ty Used	Inter-change-ability	Parts Catalog	
				Index No.	Page
A3761252	Feed Roller Guide	0 → 1	—	* 23	13

* New index

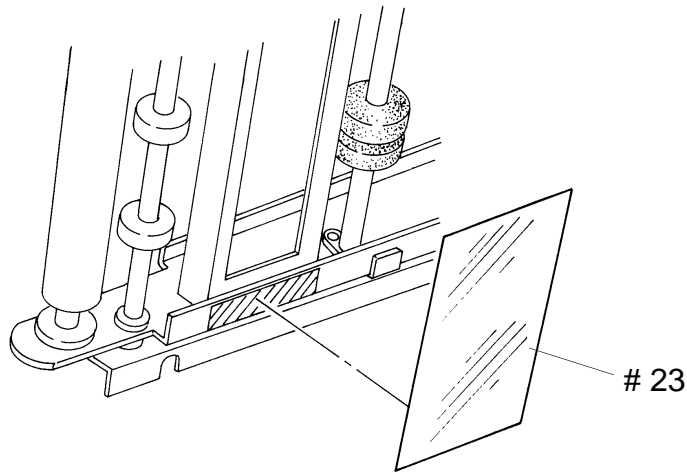

S. Hamano, Assistant General Manager
 Technical Support Department

MODEL NAME	V/Hz	DESTINATION	JAPN PRODUCTION	
			CODE	SERIAL NUMBER
NRG CRF55	120/60	U.S.A. , Canada etc.	A376 - 10	5375010001
Savin ARDF2	120/60	U.S.A	A376 - 15	4125010001
Ricoh DF60	120/60	U.S.A	A376 - 17	A3385010082
NRG CRF55	230/50	Europe etc.	A376 - 22	5325020001
Infotec ARDF VII	230/50	Europe	A376 - 26	3D80250001
Ricoh DF60	230/50	Europe etc.	A376 - 27	A3385021696

Model	DJF for F400 / 410 /420	Volt/Hz	Date of Modification	Serial Number
Modified Article	Separation Guide Mylar			
Reason for Modification	To facilitate servicing			

Draw No.	Old Parts No.	New Parts No.	Description	Rank	Q'ty Used Old→New	Inter-changeability	Parts needed for replacement by new part		Parts Catalog	
							Part No.	Description	No.	Page
	A3761187	A3761190	Separation Guide Mylar	C	1 → 1	X/O			36	11

Rank: A : Replace with new parts immediately. B : Replace with new parts at time of repair. C : Replace with new parts at time of overhaul.

Interchangeability:

(1) When old and new parts are not mutually interchangeable, use additional parts or an assembly part as indicated in "Parts needed for replacement by new part" to install the new part.

(2) The mark to the left of the slash indicates whether the old part can be used in the new machine, and the mark to the right indicates whether the new part can be used in the old machine. x = Not interchangeable o = Interchangeable

DETAILS OF MODIFICATION

New material (urethane) has been employed for the separation guide mylar. The new mylar always resets to the correct position as the transport belt turns due to its softness, even if the mylar is bent up when installing the transport belt.

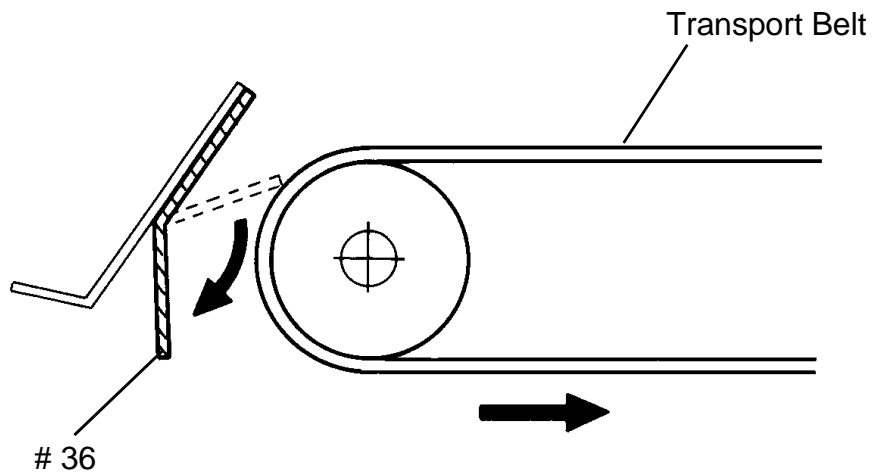

M. Iwasa, Manager
Technical Support Department

MODEL NAME	V/Hz	DESTINATION	JAPN PRODUCTION	
			CODE	SERIAL NUMBER
NRG CRF55	120/60	U.S.A. , Canada etc.	A376 - 10	5375040001
Savin ARDF2	120/60	U.S.A	A376 - 15	4125040001
Ricoh DF60	120/60	U.S.A	A376 - 17	A338505XXXX
NRG CRF55	230/50	Europe etc.	A376 - 22	5325040001
Infotec ARDF VII	230/50	Europe	A376 - 26	3D80450001
Ricoh DF60	230/50	Europe etc.	A376 - 27	A338505XXXX

Model		DJF for F400 / 410 /420					Volt/Hz	Date of Modification	Serial Number	
Modified Article		Sensor Feeler etc.								
Reason for Modification		To prevent sensor feelers from coming off								
Draw No.	Old Parts No.	New Parts No.	Description	Rank	Q'ty Used Old→New	Inter-changeability	Parts needed for replacement by new part		Parts Catalog	
							Part No.	Description	No.	Page
	A3761250	A3761272	Upper Registration Guide	C	1 → 1	X/X			14	9
	A3761259	A3761273	Sensor Feeler	C	2 → 2	X/X			12	9
		58942229	Solenoid Pin	C	0 → 2		X/O as a set		* 44	9
		07200025B	Retaining Ring - M2.5	C	0 → 2				* 112	9

Rank: A : Replace with new parts immediately. B : Replace with new parts at time of repair. C : Replace with new parts at time of overhaul.

Interchangeability:

- (1) When old and new parts are not mutually interchangeable, use additional parts or an assembly part as indicated in "Parts needed for replacement by new part" to install the new part.
- (2) The mark to the left of the slash indicates whether the old part can be used in the new machine, and the mark to the right indicates whether the new part can be used in the old machine. x = Not interchangeable o = Interchangeable

DETAILS OF MODIFICATION

To prevent the feelers for the original set and feed sensors from popping off during the operation by a customer, the mounting design has been changed from a snap-in type to a pin-fix type as shown below.

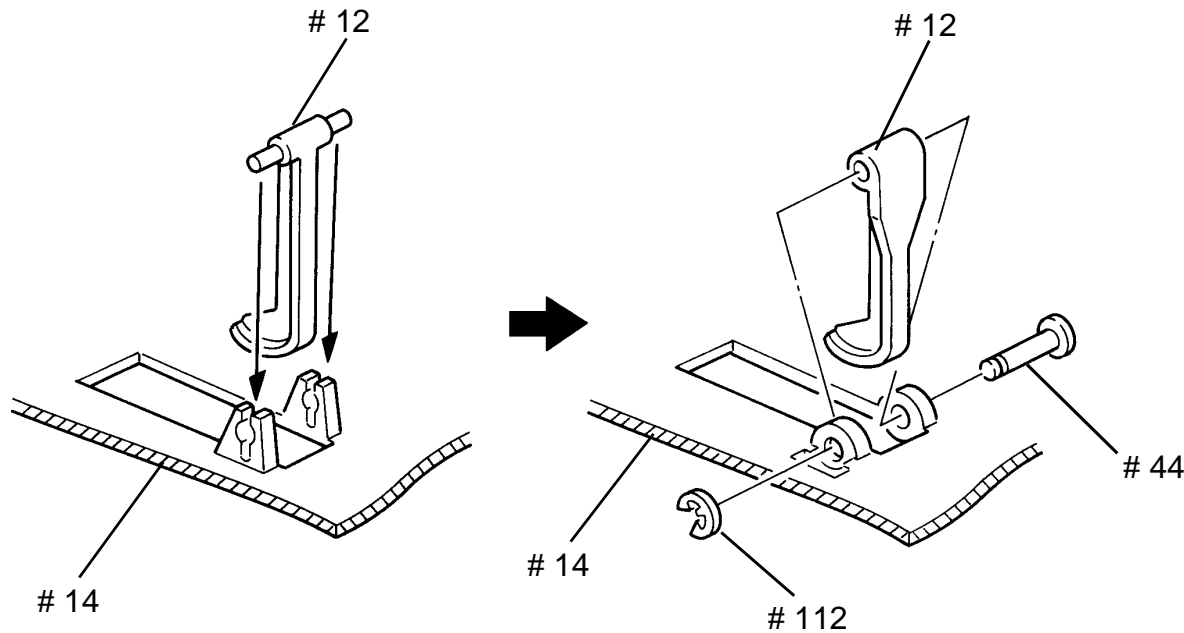

Important:

The old type sensor feeler is no longer available because the mold had been changed for the new type. Therefore, please install all the new type parts as a set when the old type feeler needs to be replaced. This action is also recommended to prevent the above problem.

M. Iwasa, Manager
 Technical Support Department

MODEL NAME	V/Hz	DESTINATION	JAPAN PRODUCTION	
			CODE	SERIAL NUMBER
NRG CRF55	120/60	U.S.A. , Canada etc.	A376 - 10	5375040001
Savin ARDF2	120/60	U.S.A	A376 - 15	4125040001
Ricoh DF60	120/60	U.S.A	A376 - 17	A338505XXXX
NRG CRF55	230/50	Europe etc.	A376 - 22	5325040001
Infotec ARDF VII	230/50	Europe	A376 - 26	3D80450001
Ricoh DF60	230/50	Europe etc.	A376 - 27	A338505XXXX

Model	DJF for F400 / 410 / 420 (Europe only)	Volt/Hz	Date of Modification	Serial Number
Modified Article	Main Board			
Reason for Modification	To meet CE mark standards			

To meet the CE mark standards, the main control board has been changed as follows:

Old P/N	New P/N	Description	Q'ty Used	Inter-change-ability	Parts Catalog	
					Index No.	Page
A3765570	A3765580	Main Board	1 → 1	X/O	22	17

M. Iwasa, Manager
Technical Support Department

MODEL NAME	V/Hz	DESTINATION	JAPAN PRODUCTION	
			CODE	SERIAL NUMBER
NRG CRF55	120/60	U.S.A. , Canada etc.	A376 - 10	537
Savin ARDF2	120/60	U.S.A	A376 - 15	412
Ricoh DF60	120/60	U.S.A	A376 - 17	A338
NRG CRF55	230/50	Europe etc.	A376 - 22	5325080209
Infotec ARDF VII	230/50	Europe	A376 - 26	3D80950001
Ricoh DF60	230/50	Europe etc.	A376 - 27	A3385091201

Model	DJF for F400 / 410 / 420	Volt/Hz	Date of Modification	Serial Number
Modified Article	Inverter Pawl			
Reason for Modification	Part standardization with other models			

The following part has been changed for part standardization purposes.

Old P/N	New P/N	Description	Q'ty Used	Inter-changeability	Parts Catalog	
					Index No.	Page
A3763142	A3763141	Inverter Pawl	1 → 1	O/O	6	15

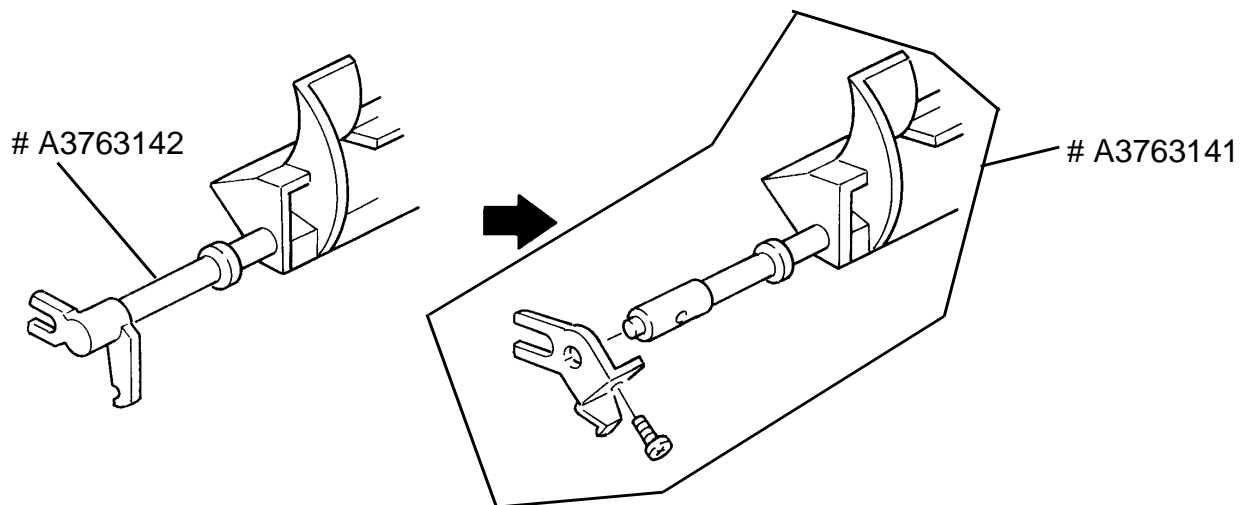

M. Iwasa, Manager
 Technical Support Department

MODEL NAME	V/Hz	DESTINATION	JAPN PRODUCTION	
			CODE	SERIAL NUMBER
NRG CRF55	120/60	U.S.A. , Canada etc.	A376 - 10	537
Savin ARDF2	120/60	U.S.A	A376 - 15	412
Ricoh DF60	120/60	U.S.A	A376 - 17	A338
NRG CRF55	230/50	Europe etc.	A376 - 22	532
Infotec ARDF VII	230/50	Europe	A376 - 26	3D8
Ricoh DF60	230/50	Europe etc.	A376 - 27	A338

Model	DJF for F400 / 410 / 420	Volt/Hz	Date of Modification	Serial Number
Modified Article	Switch Lever Bracket			
Reason for Modification	Per Field Request			

The switch lever bracket, which is originally included in the left hinge, has become available as an independent service part.

New P/N	Description	Q'ty Used	Parts Catalog	
			Index No.	Page
A3764151	Switch Lever Bracket	0 → 1	* 36	17

* New Index #

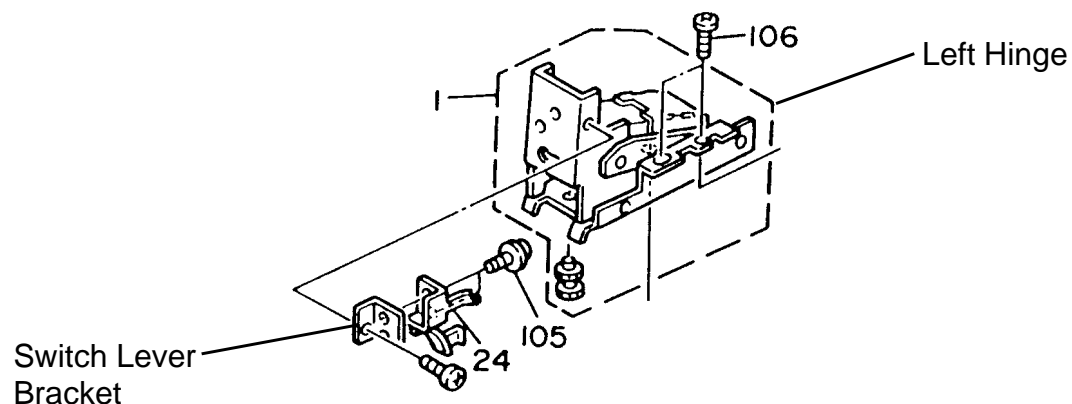

M. Iwasa, Manager
 Technical Support Department

MODEL NAME	V/Hz	DESTINATION	JAPAN PRODUCTION	
			CODE	SERIAL NUMBER
NRG CRF55	120/60	U.S.A. , Canada etc.	A376 - 10	537
Savin ARDF2	120/60	U.S.A	A376 - 15	412
Ricoh DF60	120/60	U.S.A	A376 - 17	A338
NRG CRF55	230/50	Europe etc.	A376 - 22	532
Infotec ARDF VII	230/50	Europe	A376 - 26	3D8
Ricoh DF60	230/50	Europe etc.	A376 - 27	A338

Model	DJF for F400 / 410 / 420	Volt/Hz	Date of Modification	Serial Number
Modified Article	LED - Green			
Reason for Modification	Parts catalog correction			

Please add the following to your parts catalog.

New P/N	Description	Q'ty Used	Parts Catalog	
			Index No.	Page
14030493	LED - Green	0 → n	* 117	17

* New Index

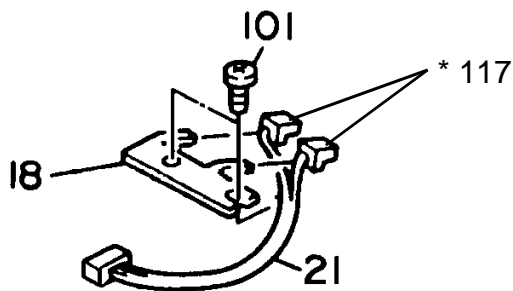

M. Iwasa, Manager
 Technical Support Department

MODEL NAME	V/Hz	DESTINATION	JAPAN PRODUCTION	
			CODE	SERIAL NUMBER
NRG CRF55	120/60	U.S.A. , Canada etc.	A376 - 10	/
Savin ARDF2	120/60	U.S.A	A376 - 15	
Ricoh DF60	120/60	U.S.A	A376 - 17	
NRG CRF55	230/50	Europe etc.	A376 - 22	
Infotec ARDF VII	230/50	Europe	A376 - 26	
Ricoh DF60	230/50	Europe etc.	A376 - 27	

Model	DJF for F400 / 410 / 420 / DJF-α	Volt/Hz	Date of Modification	Serial Number
Modified Article	Bracket - Idle Roller Arm			
Reason for Modification	To maintain the pressure of the pull-out roller			

Incorrect P/N	Correct P/N	Description	Q'ty Used	Inter-change-ability	Parts Catalog	
					Index No.	Page
A376 1223	A376 1224	Bracket-Idle Roller Arm	2 → 2	X/O	3	7

Over time, wear on the pull-out roller leads to a decrease in pressure (as well as a reduction in the gap) and may result in original jams or incorrect size detection.

To prevent this, the position of the stud (A) in the bracket-idle roller arm has been raised by 1 mm to maintain the pressure.

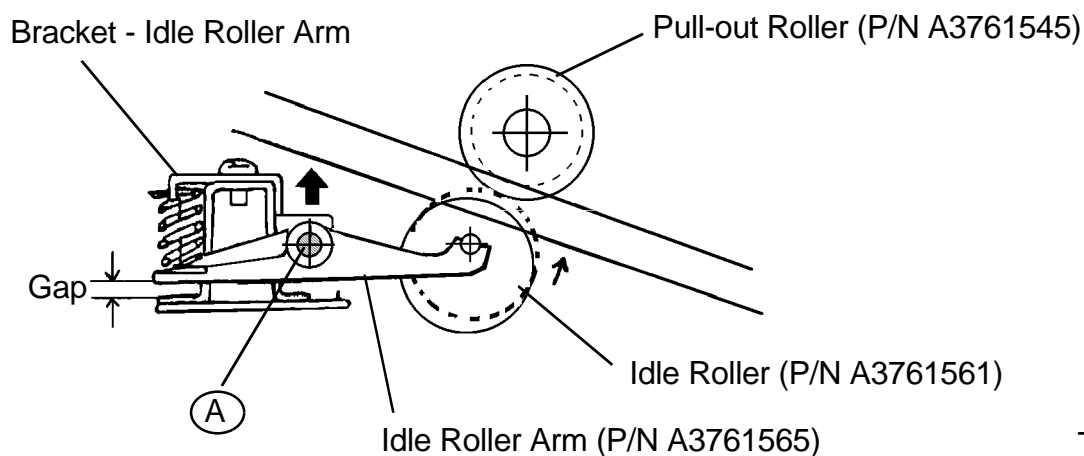

T. Inoue
 T. Inoue, General Manager
 1st Field Information Dept. QAC

MODEL NAME	V/Hz	DESTINATION	JAPAN PRODUCTION	
			CODE	SERIAL NUMBER
NRG CRF55	120/60	U.S.A. , Canada, etc.	A376 - 10	5376070001
Savin ARDF2	120/60	U.S.A	A376 - 15	412608XXXX
Ricoh DF60	120/60	U.S.A	A376 - 17	A3386070348
NRG CRF55	230/50	Europe, etc.	A376 - 22	5326070001
Infotec ARDF VII	230/50	Europe	A376 - 26	3D8086XXXX
Ricoh DF60	230/50	Europe, etc.	A376 - 27	A3386075001
Sharp AR-A80	120/60	USA	A376 - 57	S126075001
Sharp AR-A80	230/50	Europe	A376 - 67	S12608XXXX